

## Executive Summary

### Tract Level Summary of the Ferguson Tract

Lee County, KY

2,864 Acres

Effective Date 01/26/2004

Land	Quantity	Unit
Timbered		
Upland		Acres
Bottomland		Acres
Slope	2,864.00	Acres
Total	2,864.00	Acres

**Total Land** 2,864.00 Acres

Total Merchantable Acres 2,864.00

Total Tract Acreage 2,864.00

#### Merchantable Timber

Species	Product	Quantity	Unit	Growth Rates
Pine	Pulpwood (w/tops)	484.30	Cords	6.64%
	Small Sawtimber	339.00	Cords	2.88%
	Large Sawtimber	290.10	Cords	2.88%
	Total Pine	1,113.40	Cords	
Hemlock	Pulpwood (w/tops)	444.60	Cords	2.88%
	Total Hemlock	444.60	Cords	
Hardwood Pulpwood	Soft Hdwood Pulp	7,242.50	Cords	3.80%
	Hard Hdwood Pulp	29,238.30	Cords	3.80%
	Total Hardwood Pulp	36,480.80	Cords	
Hard Hardwood	Large Sawtimber	650.90	MBF,D	2.67%
	Total Hard Hwd.	650.90	MBF,D	
Black Oak	Large Sawtimber	1,215.50	MBF,D	2.67%
	Tie / Pallet	2.81	MBF,D	2.67%
	Total Black Oak	1,218.31	MBF,D	
Scarlet Oak	Large Sawtimber	706.45	MBF,D	2.67%
	Total Scarlet Oak	706.45	MBF,D	
Red Oak	Large Sawtimber	568.63	MBF,D	2.67%
	Tie / Pallet	4.93	MBF,D	2.67%
	Total Red Oak	573.56	MBF,D	
White Oak	Large Sawtimber	1,979.37	MBF,D	2.67%
	Tie / Pallet	4.93	MBF,D	2.67%
	Total White Oak	1,984.30	MBF,D	
Chestnut Oak	Large Sawtimber	741.79	MBF,D	2.67%
	Tie / Pallet	10.14	MBF,D	2.67%
	Total Chestnut Oak	751.93	MBF,D	
Walnut	Large Sawtimber	20.90	MBF,D	2.67%
	Total Walnut	20.90	MBF,D	
Ash	Large Sawtimber	68.63	MBF,D	2.67%
	Tie / Pallet	5.84	MBF,D	2.67%
	Total Ash	74.47	MBF,D	
Soft Hardwood	Large Sawtimber	511.71	MBF,D	2.67%
	Total Soft Hardwood	511.71	MBF,D	
Polpar	Large Sawtimber	739.17	MBF,D	2.67%
	Total Polpar	739.17	MBF,D	
Maple	Large Sawtimber	190.14	MBF,D	2.67%
	Total Maple	190.14	MBF,D	

F & W FORESTRY SERVICES, INC.

For more detailed volume information see the "Volume Summary" section of this report.

## Confidence Intervals for Merchantable Volume Estimates of Basal Area per Acre

**Ferguson Tract  
Lee County, Kentucky  
January 26, 2004**

Compartment Number	Acres	Samples	Mean	CI-68 (%)	CI-90 (%)	CI-95 (%)	CI-99 (%)	CV (%)
<b>1</b>	1,095.5	221	65.82	2.8	4.6	5.5	7.3	42.0
<b>2</b>	749.8	149	79.53	2.3	3.9	4.7	6.1	29.1
<b>3</b>	1,018.7	195	94.30	1.9	3.3	3.9	5.1	27.7
<b>Tract Total</b>	<b>2,864.0</b>	<b>565</b>	<b>79.54</b>	<b>1.3</b>	<b>2.3</b>	<b>2.7</b>	<b>3.5</b>	<b>32.7</b>

- 1) CI-95 refers to the 95% confidence interval for the mean basal area per acre as a percent of the mean
- 2) CV(%) - the coefficient of variation, which represents the variability between samples, on a percent basis
- 3) Total compartment acreage represents the total acres in merchantable timber

## Confidence Intervals for Merchantable Volume Estimates in Board Feet per Acre

**Ferguson Tract  
Lee County, Kentucky  
January 26, 2004**

Compartment Number	Acres	Samples	Mean	CI-90 (%)	CI-95 (%)	CI-99 (%)	CV (%)
<b>1</b>	1,095.5	221	2,062.80	8.5	10.2	13.4	77.2
<b>2</b>	749.8	149	2,594.81	8.0	9.6	12.6	59.7
<b>3</b>	1,018.7	195	3,255.34	7.3	8.8	11.5	62.4
<b>Tract Total</b>	<b>2,864.0</b>	<b>565</b>	<b>2,626.25</b>	<b>4.6</b>	<b>5.5</b>	<b>7.2</b>	<b>66.9</b>

- 1) CI-95 refers to the 95% confidence interval for the mean board foot volume per acre as a percent of the mean
- 2) CV(%) - the coefficient of variation, which represents the variability between samples, on a percent basis
- 3) Board foot volumes are based on Mesavage and Girard volume tables (large sawtimber trees only)
- 4) Total compartment acreage represents the total acres in merchantable timber

## Confidence Intervals for Merchantable Volume Estimates in Cords per Acre

**Ferguson Tract  
Lee County, Kentucky  
January 26, 2004**

Compartment Number	Acres	Samples	Mean	CI-90 (%)	CI-95 (%)	CI-99 (%)	CV (%)
<b>1</b>	1,095.5	221	19.70	4.8	5.7	7.5	43.4
<b>2</b>	749.8	149	23.49	4.2	5.0	6.6	31.2
<b>3</b>	1,018.7	195	29.06	3.4	4.1	5.3	28.9
<b>Tract Total</b>	<b>2,864.0</b>	<b>565</b>	<b>24.02</b>	<b>2.4</b>	<b>2.8</b>	<b>3.7</b>	<b>34.1</b>

1) CI-95 refers to the 95% confidence interval for the mean cords per acre as a percent of the mean

2) CV(%) - the coefficient of variation, which represents the variability between samples, on a percent basis

3) Total compartment acreage represents the total acres in merchantable timber

## Confidence Intervals for Merchantable Volume Estimates in Cubic Feet per Acre

**Ferguson Tract  
Lee County, Kentucky  
January 26, 2004**

Compartment Number	Acres	Samples	Mean	CI-90 (%)	CI-95 (%)	CI-99 (%)	CV (%)
1	1,095.5	221	16.49	4.9	5.8	7.6	44.1
2	749.8	149	19.69	4.0	4.8	6.3	30.0
3	1,018.7	195	23.55	3.5	4.2	5.5	29.6
Tract Total	2,864.0	565	19.84	2.4	2.8	3.7	34.4

- 1) CI-95 refers to the 95% confidence interval for the mean cubic foot volume per acre as a percent of the mean
- 2) CV(%) - the coefficient of variation, which represents the variability between samples, on a percent basis
- 3) Total compartment acreage represents the total acres in merchantable timber

## Confidence Intervals for Merchantable Weight Estimates in Tons per Acre

**Ferguson Tract  
Lee County, Kentucky  
January 26, 2004**

Compartment Number	Acres	Samples	Mean	CI-90 (%)	CI-95 (%)	CI-99 (%)	CV (%)
<b>1</b>	1,095.5	221	55.03	4.8	5.7	7.5	43.5
<b>2</b>	749.8	149	65.58	4.2	5.0	6.6	31.3
<b>3</b>	1,018.7	195	80.95	3.4	4.1	5.4	29.0
Tract Total	2,864.0	565	67.01	2.4	2.8	3.7	34.2

- 1) CI-95 refers to the 95% confidence interval for the mean weight per acre as a percent of the mean
- 2) CV(%) - the coefficient of variation, which represents the variability between samples, on a percent basis
- 3) Total compartment acreage represents the total acres in merchantable timber

## Confidence Intervals for Merchantable Estimates of Trees per Acre

Ferguson Tract  
Lee County, Kentucky  
January 26, 2004

Compartment Number	Acres	Samples	Mean	CI-90 (%)	CI-95 (%)	CI-99 (%)	CV (%)
1	1,095.5	221	103.03	6.1	7.2	9.5	55.0
2	749.8	149	122.87	5.9	7.1	9.3	44.0
3	1,018.7	195	141.74	4.8	5.7	7.5	40.7
Tract Total	2,864.0	565	121.99	3.2	3.8	5.0	46.2

- 1) CI-95 refers to the 95% confidence interval for the mean trees per acre as a percent of the mean
- 2) CV(%) - coefficient of variation, which represents the variability between samples, on a percent basis
- 3) Total compartment acreage represents the total acres in merchantable timber

**Acreages Sorted by Description**

**Ferguson Tract  
Lee County, Kentucky  
February 11, 2004**

<u>Description</u>	<u>Acres</u>
NSMH-1950	2,864.00
Total	2,864.00

## Forested Acres by Land Type and Tract

### Ferguson Tract February 11, 2004

Tract Name	Forested Land					Non Forested Land	Total
	Upland	Lowland	BottomLand	Slope	Old Field		
Ferguson				2,864.00			2,864.00
<b>Total</b>				<b>2,864.00</b>			<b>2,864.00</b>

Forested Acres include existing timbered stands and recently cutover stands.

Upland Acres include areas where the topography does not limit the artificial regeneration of pine.

Lowland Acres include areas where drainage limits the artificial regeneration of pine.

Bottomland Acres include areas that cannot be artificially regenerated to pine because of drainage.

Slope Acres include areas where slope limits harvesting activities and artificial regeneration of pine.

Old Field Acres include areas that were farmed prior to planting the existing stand.

# FERGUSON TRACT COMPARTMENT 1 LEE COUNTY, KENTUCKY 1095.45 ACRES

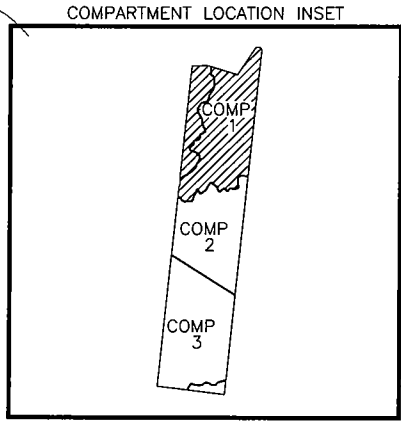
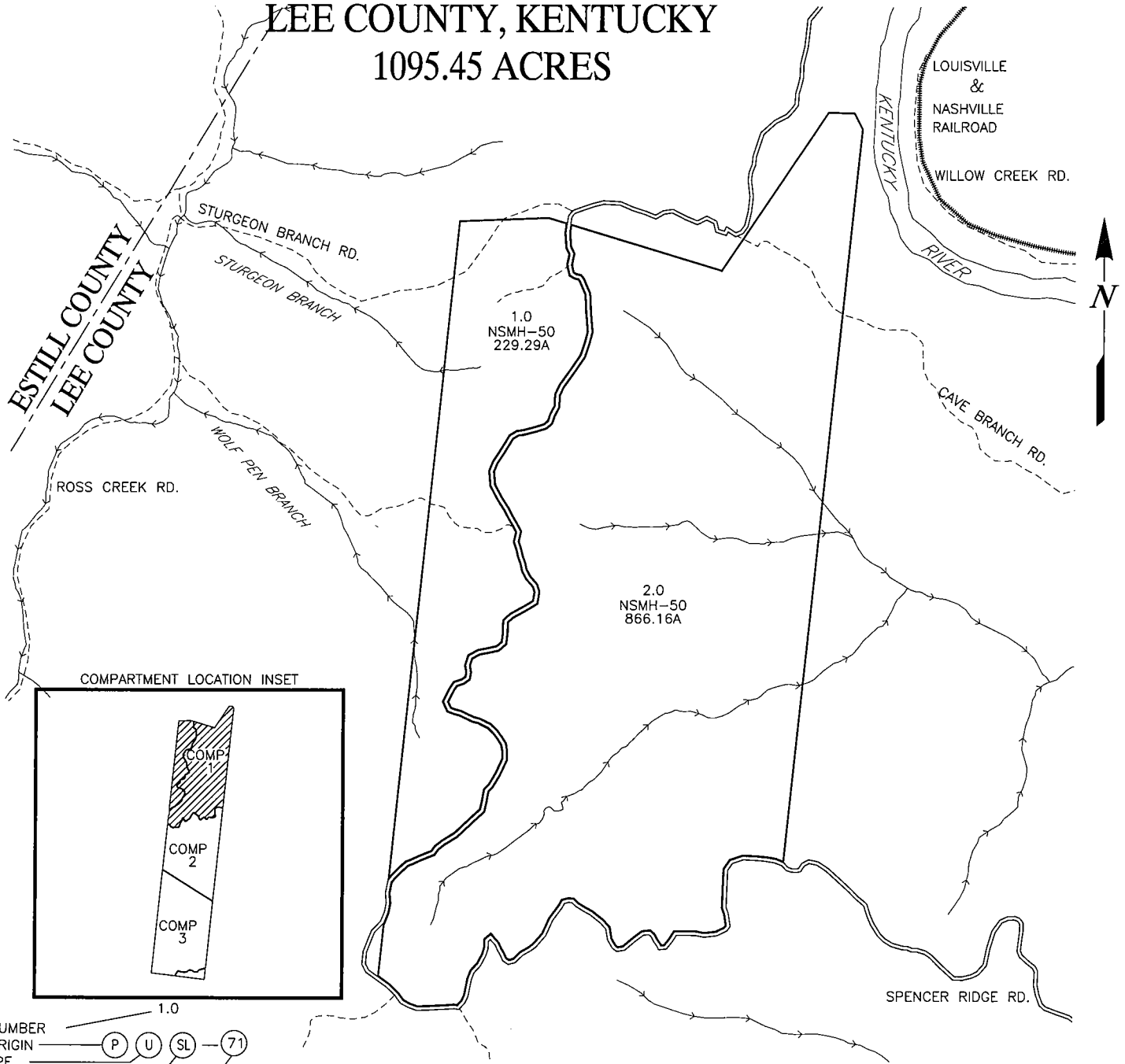

**KEY**

STAND NUMBER	1.0
STAND ORIGIN	(P) (U) (SL) (71)
LAND TYPE	
ACREAGE	25A
SPECIES	
YEAR OF ORIGIN	

FEATURES	SYMBOL
Property Boundary	—
Compartment Boundary	— · — · — · — · —
Woods Road	— · — · — · — · —
Paved Road	=====
Graded Road	=====
Type Boundary	— · — · — · — · —
Creek	~~~~~
Fence	-x-x-x-
Olding road	■
itch	

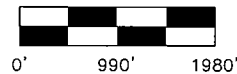

**LEGEND**

STAND ORIGIN CODES	N=NATURAL
LAND TYPE CODES	S=SLOPE
SPECIES CODES	MH=MIXED HARDWOOD

DRAWN BY: T.JONES  
 LAST MAP UPDATE  
 Feb 06, 2004 - 4:26:55  
 STAND DATE: 20040204  
 MGMT. STATUS: C\_040204

FEBRUARY 2004

**Stand Description and Acres**

**Ferguson Tract  
Lee County, Kentucky  
February 11, 2004**

**2864.00 Acres**

***Compartment 1***

Stand		
Number	Description	Acres
1.0	NSMH-1950	229.29
2.0	NSMH-1950	866.16
Total		1,095.45

**Acreages Sorted by Description**

**Ferguson Tract  
Lee County, Kentucky  
February 11, 2004**

***Compartment 1***

<u>Description</u>	<u>Acres</u>
NSMH-1950	1,095.45
Total	1,095.45

COMPARTMENT LOCATION INSET

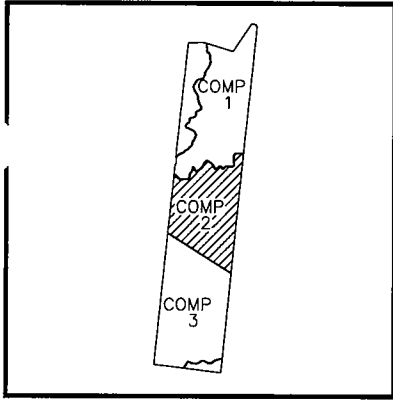

# FERGUSON TRACT COMPARTMENT 2 LEE COUNTY, KENTUCKY 749.83 ACRES

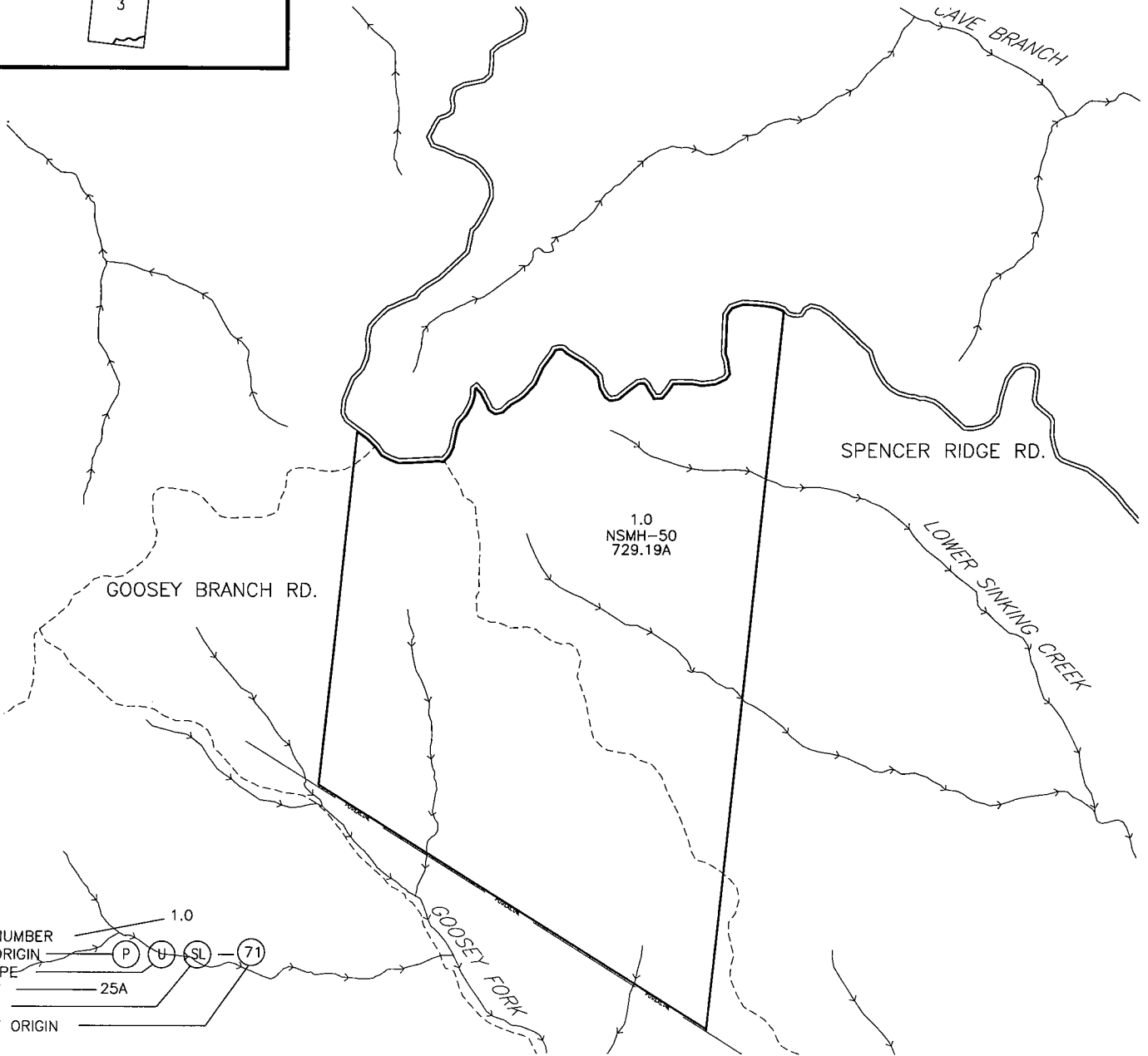
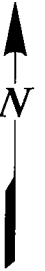

**KEY**

STAND NUMBER	1.0
STAND ORIGIN	(P) (U) (SL) (71)
LAND TYPE	
ACREAGE	25A
SPECIES	
YEAR OF ORIGIN	

FEATURES	SYMBOL
Property Boundary	—————
Compartment Boundary	- - - - -
Woods Road	—————
Paved Road	—————
Graded Road	—————
Type Boundary	—————
Creek	~~~~~
F	x x x
3	■
road	
Ditch	~~~~~

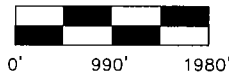

**LEGEND**

STAND ORIGIN CODES	N=NATURAL
LAND TYPE CODES	S=SLOPE
SPECIES CODES	MH=MIXED HARDWOOD

DRAWN BY: T.JONES  
 LAST MAP UPDATE  
 Feb 06, 2004 - 4:23:42  
 STAND DATE: 20040204  
 MGMT. STATUS: C\_040205

**Stand Description and Acres**

**Ferguson Tract  
Lee County, Kentucky  
February 11, 2004**

**2864.00 Acres**

***Compartment 2***

Stand		
Number	Description	Acres
1.0	NSMH-1950	749.83
Total		749.83

**Acreages Sorted by Description**

**Ferguson Tract  
Lee County, Kentucky  
February 11, 2004**

***Compartment 2***

<u>Description</u>	<u>Acres</u>
NSMH-1950	749.83
<b>Total</b>	<b>749.83</b>

COMPARTMENT LOCATION INSET

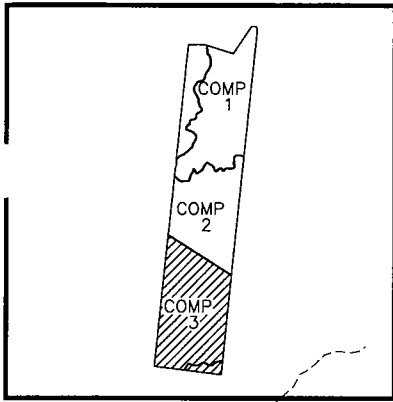

# FERGUSON TRACT COMPARTMENT 3 LEE COUNTY, KENTUCKY 1018.72 ACRES

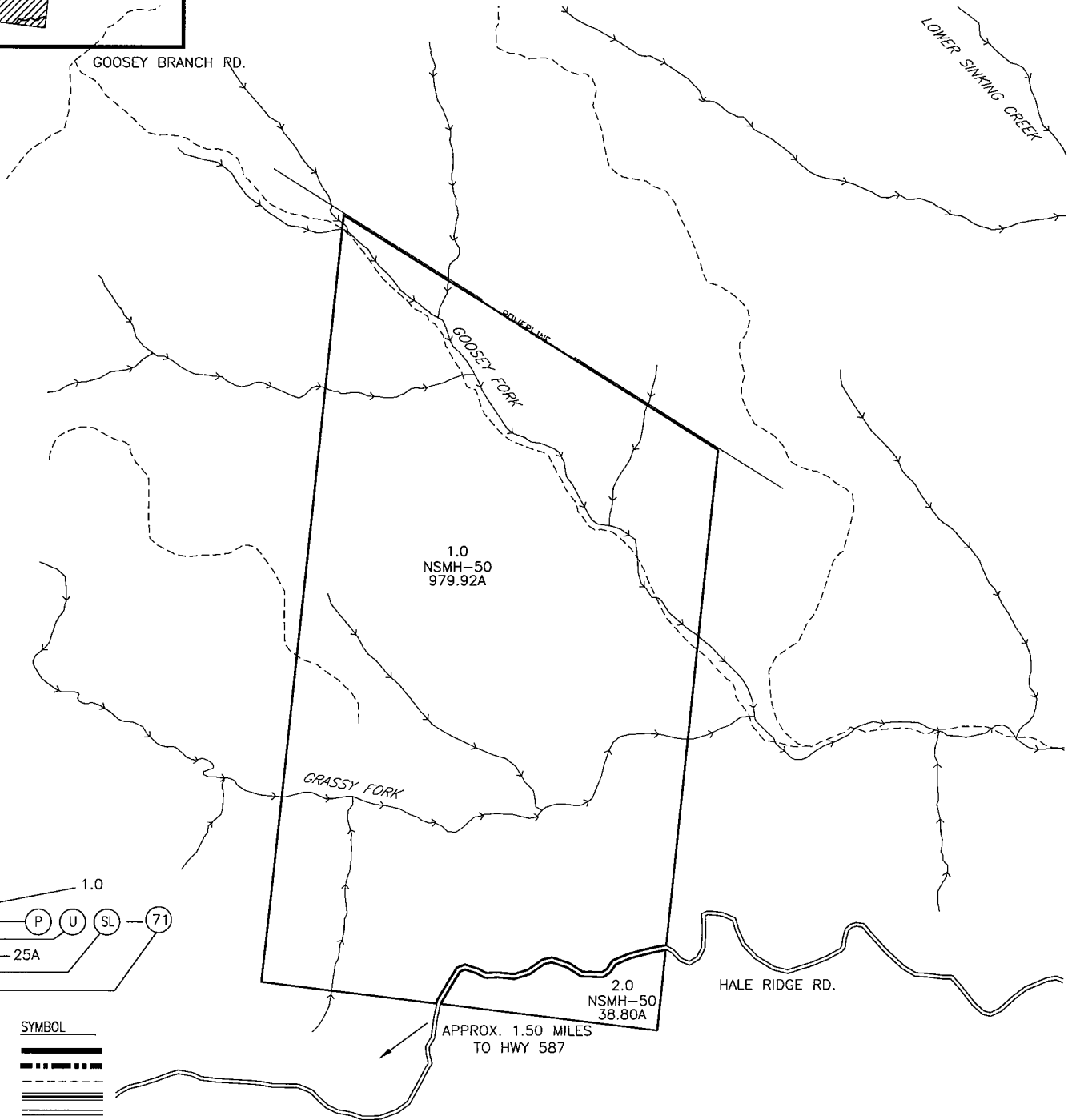
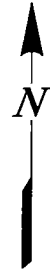

**KEY**

STAND NUMBER	1.0
STAND ORIGIN	(P) (U) (SL) (71)
LAND TYPE	
ACREAGE	25A
SPECIES	
YEAR OF ORIGIN	

FEATURES	SYMBOL
Property Boundary	—————
Compartment Boundary	- - - - -
Woods Road	=====
Paved Road	=====
Graded Road	=====
Type Boundary	=====
Creek	~~~~~
Gravel Road	- x - x - x -
Ditch	

DRAWN BY: T.JONES  
 LAST MAP UPDATE  
 Feb 06, 2004 - 4:21:40  
 STAND DATE: 20040204  
 MGMT. STATUS: C\_040204

FEBRUARY 2004

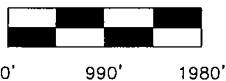

**LEGEND**

STAND ORIGIN CODES	N=NATURAL
LAND TYPE CODES	S=SLOPE
SPECIES CODES	MH=MIXED HARDWOOD

**Stand Description and Acres**

**Ferguson Tract  
Lee County, Kentucky  
February 11, 2004**

**2864.00 Acres**

***Compartment 3***

Stand		
Number	Description	Acres
1.0	NSMH-1950	979.92
2.0	NSMH-1950	38.80
Total		1,018.72

**Acreages Sorted by Description**

**Ferguson Tract  
Lee County, Kentucky  
February 11, 2004**

***Compartment 3***

<u>Description</u>	<u>Acres</u>
NSMH-1950	1,018.72
Total	1,018.72